



BESPOKE PLAYSAPCES



Windsor Reserve, Auckland

Planning, conceptual design, comprehensive rendering, and implementation – the playspace design process is a complex one. Playco can help by providing expert planning, design, and construction management services to deliver your playground to plan and budget.

bespoke:

adjective

- ◇ **made for a particular customer or user**
 - ◇ **making or selling bespoke goods**
-



CLIENT: AUCKLAND COUNCIL

PARTNERS: PROLUDIC, GSWEB

EQUIPMENT BUDGET: \$400,000 - 500,000

THEME:

Nautical, incorporating the features of the area including a lighthouse

Built in 1870 and still in use today, Auckland's Waitemata Harbour is proud to boast the oldest wooden lighthouse in New Zealand. The unique lighthouse was the inspiration for the bespoke playspace opened in 2020 in the vibrant seaside village of Devonport.

Engaged by Auckland Council to provide conceptual plans for a new playspace, WSPs focus very quickly turned to the natural seascape nearby and the focal point of the Waitemata Harbour – Bean Rock. Bean Rock features one of Auckland's Category One registered lighthouses, registered under the Historic Places Act. The inspiration for Windsor Park draws on the natural beauty of Bean Rock, its lighthouse and the surrounding reef and seascape.

WINDSOR RESERVE

DEVONPORT, AUCKLAND



The design brief focused on creating a scaled down version of the lighthouse standing at 8m tall.

Working together with our French partner Proludic, Playco created the tailored lighthouse to match the specification within the brief down to the millimeter.

With a specific colour pallet Playco were able to work with Proludic to ensure the lighthouse would be delivered exactly as required by the architect.

Play elements include:

- ◇ kinetic play
- ◇ rope play
- ◇ slides
- ◇ talk tubes
- ◇ inclusive play
- ◇ trampolines
- ◇ springers
- ◇ carousels
- ◇ sandplay
- ◇ swings



PLAYCO'S RENDER OF PROJECT









CLIENT: RCL

PARTNERS: PROLUDIC

EQUIPMENT BUDGET: \$300,000 - 400,000

THEME:

Wooden elements to blend
in with the area

HANLEY'S FARM

QUEENSTOWN

Set in picturesque Queenstown, Hanley's Farm is located on a 3-kilometre stretch of land, sitting harmoniously between Lake Wakatipu, Deer Park Heights and The Remarkables.

A new family oriented sub-division, Hanley's Farm enjoys exquisite views from all aspects. Developer, RCL engaged Park Central to design the playspace. Park Central provided a concept design and requested a custom design that reflected the history of the surrounding areas, basing the design on a water-tower.

Approached by Park Central, Playco were asked to further the develop the design of a circular large wooden structure with three levels within; we were the only design team able to meet this intricate brief in every respect.



The brief included a round, wooden three-level tower, with slatted cladding to replicate that of an old water storage tower. The tower features two large slides that cater for different abilities and age ranges.

Meeting that element of the brief, the client and Park Central furthered the challenged us by asking for the design and build of a stainless steel connect swing that stood over 4m tall, to act as a beacon on the top of the hill. This swing became New Zealand's largest connect swings, guaranteed to thrill!

Play elements include:

- ◇ kinetic play
- ◇ rope play
- ◇ slides
- ◇ inclusive play
- ◇ trampolines
- ◇ carousels
- ◇ sandplay
- ◇ swings
- ◇ natural play



ARCHITECT'S CONCEPT

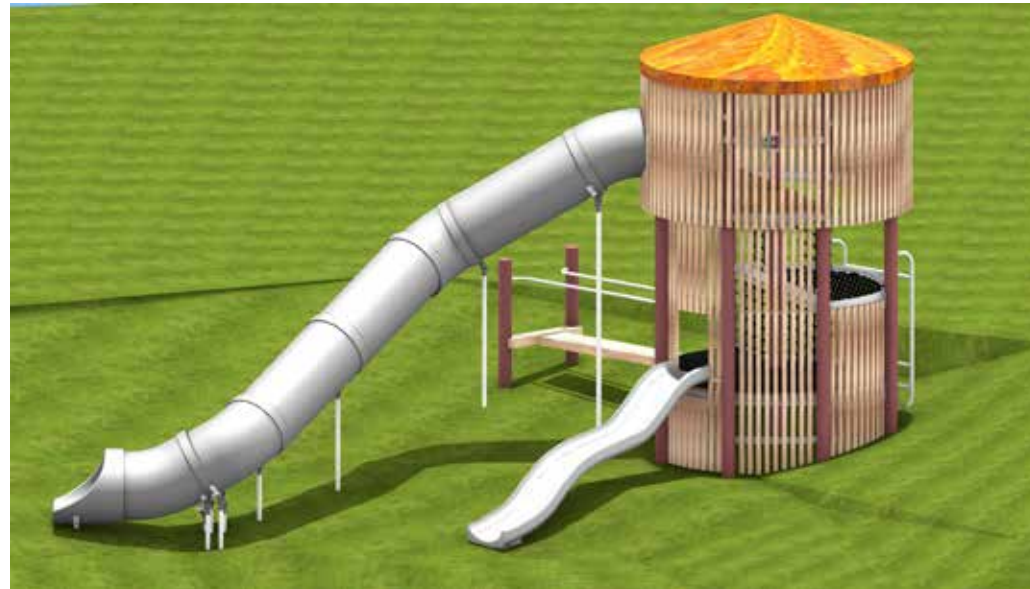

PLAYCO'S RENDER OF PROJECT





CLIENT: HASTINGS DISTRICT COUNCIL

PARTNERS: PROLUDIC, GSWEB

EQUIPMENT BUDGET: \$550,000 - 650,000

THEME:

Nature, acorns, autumn leaves and meandering streams

CORNWALL PARK

HASTINGS

The oldest parkland in Hastings, Cornwall Park is home to hundreds of mature trees, some of which date back to the 1920s when the park was first established.

Embracing the nature theme, Hastings District Council chose our GSWeb Acorn Tower for its main playspace feature.

Working with Creo Architects, a theme of acorns, autumn leaves, and meandering streams was conceptualised.

Being a large piece in a small play space, the Acorn Tower provides a sense of scale. The 10m height of the structure allows climbers to be up in the trees, looking down on the playground below.



All equipment was designed to wrap around the main structure, providing different play experiences for children to discover as they move through the play space.

When selecting the equipment for the play space, equipment was chosen that not only covered a wide range of ages, but also a range of abilities. Equipment such as inground mini-trampolines, ramped play structures with sensory panels, and large open basket swings, all provide accessible play options.

Play elements include:

- ◇ kinetic play
- ◇ rope play
- ◇ slides
- ◇ inclusive play
- ◇ trampolines
- ◇ springers
- ◇ carousels
- ◇ swings
- ◇ natural play



ARCHITECT'S CONCEPT



PLAYCO'S RENDER OF PROJECT









CLIENT: PALMERSTON NORTH DISTRICT COUNCIL

PARTNERS: PROLUDIC

EQUIPMENT BUDGET: \$120,000 - 130,000

THEME:

A natural twist on play

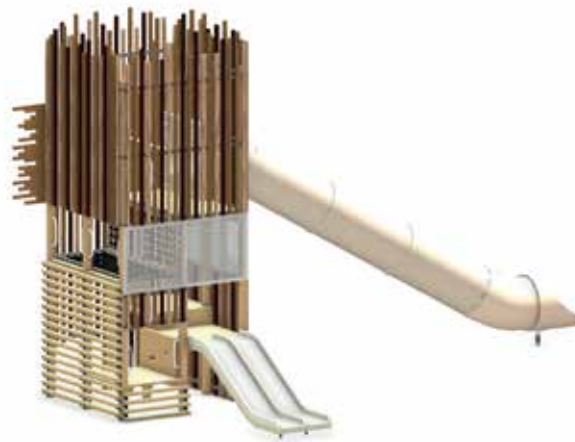

“The concept is to encourage children to be creative in their play, and use nature as part of the play experience.”

City council parks and reserves manager Kathy Dever-Tod

Putting a natural twist on the concept of play using soft colours, gardens and landscaping to blend the new features into the park, Milverton is a wonderland for children to explore. The equipment was crafted out of natural materials where possible, while the design encourages parents to get involved with their children. The high-rise fort was designed to give children the feeling of being up amongst the trees.

The gardens that would form a soft, safety boundary around and under the play equipment would be part of the set-up, with children free to touch and feel the growing plants.

MILVERTON PARK

PALMERSTON NORTH





CLIENT: AUCKLAND COUNCIL

PARTNERS: GSWEB, PROLUDIC

EQUIPMENT BUDGET: \$350,000 - 450,000

THEME:

Water, ecology, refuge,
connection, events & history

Designed to be a retreat on the fringes of Auckland city centre, Western Springs new playspace celebrates the significant ecological area.

Called an Ecological Escape, the modernised space includes play equipment and zoned areas of play suitable for children of all ages and abilities.

Western Springs sits in a green corridor, with the park surrounded by the popular regional facilities of Auckland Zoo, MOTAT and Western Springs Stadium.



WESTERN SPRINGS

AUCKLAND

Meandering pathways between the play zones double as beginner bike riding tracks. New and improved pathways, seating, BBQs, drinking fountains, shade sails and shade trees also feature.

Accessibility is prioritised with a combination of new surfaces introduced; the removal of steps and ridges to make sure wheelchairs, prams and those with impaired mobility can use the play area easily.

Play elements include:

- ◇ kinetic play
- ◇ rope play
- ◇ slides
- ◇ inclusive play
- ◇ springers
- ◇ carousels
- ◇ swings
- ◇ natural play



ARCHITECT'S CONCEPT



PLAYCO'S DESIGN



PLAYCO'S RENDER OF PROJECT



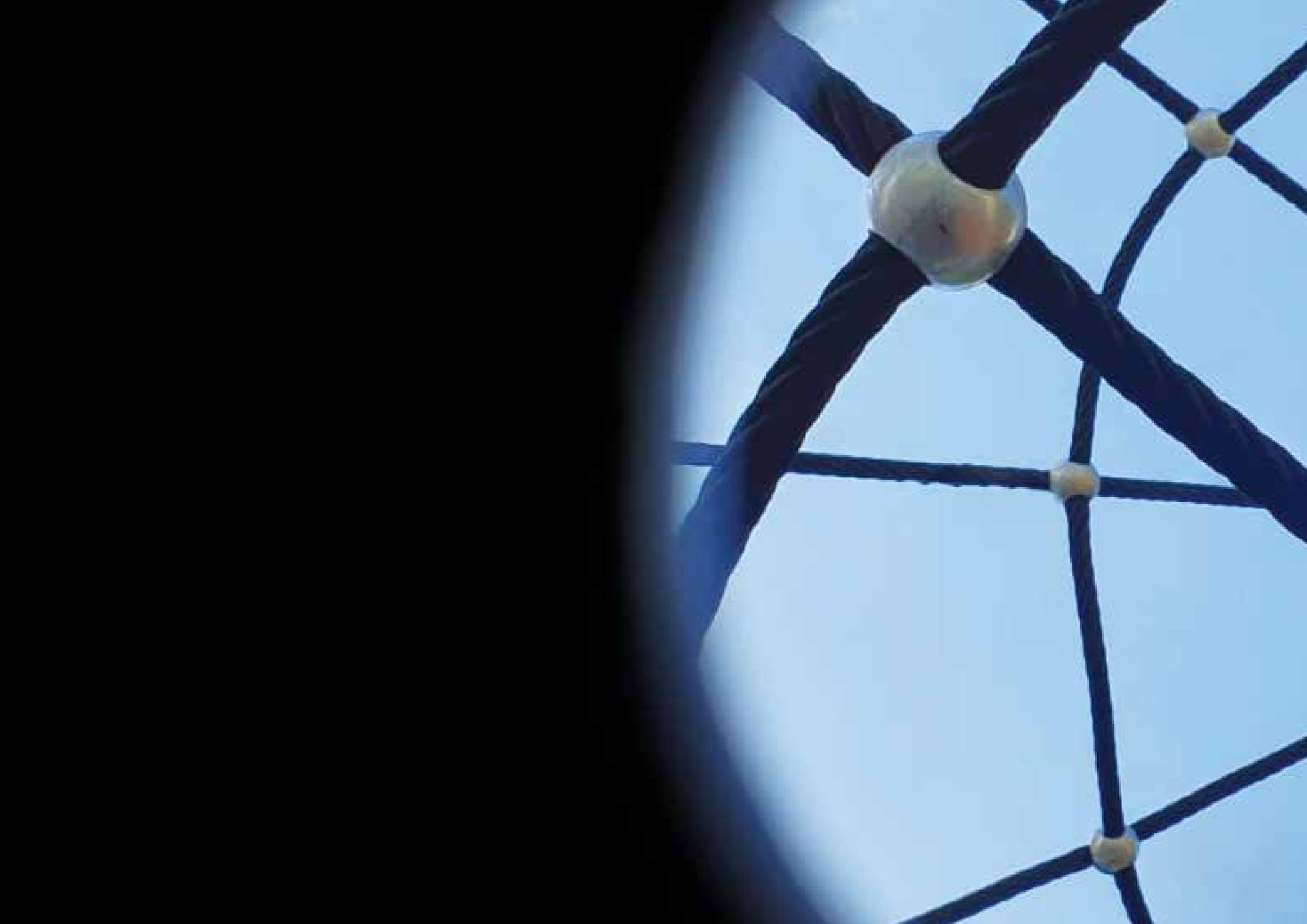





CLIENT: AUCKLAND COUNCIL

PARTNERS: PLAYCO

EQUIPMENT BUDGET: \$120,000 - 140,000

THEME:

Exploration

HOME RESERVE

AUCKLAND

Playco designed and built this two storey tower to be an attention grabber from the street above.

Small but packed full of fun, Home Reserve is a park where neighbours can meet and watch their children play and have fun together, whilst they catch up at this family-friendly playground.

As the park is partially fenced, Auckland Council wanted a feature piece of equipment to be seen from the road above. Our wooden tower has two level and two slides



The half-basketball court is fun for young kids, teenagers and adults to shoot some hoops and enjoy playing basketball outside with their friends. With the half court, kids can learn how to take turns playing offensive and defensive roles, practice dribbling as well as play some fun basketball shooting games together.

Play elements include:

- ◇ rope play
- ◇ slides
- ◇ natural play



PLAYCO'S DESIGN

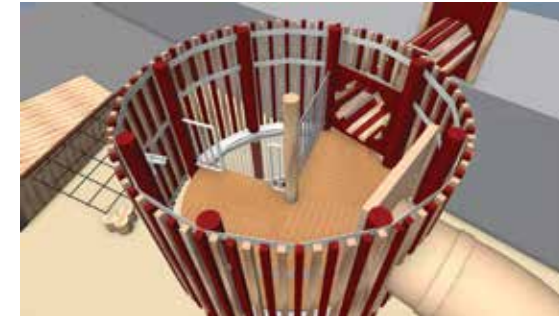

PLAYCO'S DESIGN



PLAYCO'S RENDER OF PROJECT





CLIENT: AUCKLAND COUNCIL

PARTNERS: GSWEB

EQUIPMENT BUDGET: \$120,000 - 150,000

THEME:

Nature trail



KAHAWAIRAHI RESERVE

AUCKLAND

Engaged by WSP on behalf of Auckland Council, Playco designed and built a natural playspace.

A community driven project from the start, the playground at Kahawairahi Drive Reserve in Beachlands is a beautiful nature trail, including climbing nets, a massive tunnel slide, high swings, half court, dedicated toddler playground and water and sand play.









Playco Equipment Limited

P 0800 76 46 76 +64 9 412 2247

PO Box 548 Kumeu 0841 Auckland New Zealand

E sales@playco.co.nz

W www.playco.co.nz